



ULTRA BASE
SYSTEMS

PRE-PACKAGED

DESIGNER GREENS



**Creating your backyard oasis has never
been this easy or affordable**

Table of Contents

Introduction	3
List Of Tools	5
Parts Identifier	6
Product Identification Drawings	8-15
Installation	16-22
Warranty	23



Proudly made in the USA from 100%
recycled and recyclable materials.

866.921.7888 | 727.391.9009
www.UltraBaseSystems.com | www.TourLinks.net

© 2021 Innovative Base Technologies, LLC



The success of the Tour Links pre-packaged greens has been amazing. From the U.S. to India, golfers of all skill levels have benefited from the quality and realism that is Tour Links. Our wide range of price points has allowed golfers of nearly any budget to own their own personal putting green and practice in the privacy of their own home or office.

However, the customer wanted more. For most golfers bigger is better, so we are offering our new line of Pre-packaged Designer greens. The following manual will show any installer just how easy it is to create a built in looking green, in nearly any environment, in a fraction of the time. We have done most of the work for you. Pre-cut panels, pre-cut putting green turf and fringe will turn any installer into an expert immediately. Your job is to prepare the site and assemble. UltraBaseSystems has done the rest.

So, carefully read the following set up procedures and refer to **<https://ultrabasesystems.com/new-designer-greens/>** for great tips on how to prepare your site location prior to installation. I am confident you will agree, that once again, Tour Links has changed the way putting greens will be sold and installed around the world.



Proudly made in the USA from 100%
recycled and recyclable materials.

866.921.7888 | 727.391.9009
www.UltraBaseSystems.com | www.TourLinks.net

© 2021 Innovative Base Technologies, LLC



WARNING!

READ AND UNDERSTAND OPERATOR'S MANUAL
BEFORE USING THIS UNIT.

FAILURE TO FOLLOW OPERATING INSTRUCTIONS
COULD RESULT IN INJURY OR DAMAGE TO PROPERTY.

NOTICE TO ASSEMBLERS

ALL UltraBaseSystems® Putting Green Systems, including those used for DISPLAYS, MUST be assembled with fasteners according to the instructions. Failure to follow instructions could result in INJURY.

IMPORTANT! Remove all contents from boxes.

This putting green was designed to be used for play outdoors.

Portability: All of the panels interlock for ease of assembly and disassembly. To move or store the putting green you must disassemble EACH interlocking panel from each other for safety in moving. Two people are required for safe assembly and disassembly.

Drainage: Spacing between the joints of the panels allows the drainage of water off the deck when used outdoors.

Be sure to locate the green on a well draining surface and pitch the ground to allow for proper water evacuation.



SAFETY INSTRUCTIONS



- Two (2) people are recommended for this operation.
- The life of your putting green depends on many conditions. The climate, placement of the green, exposure to corrosives such as pesticides, herbicides, or salts are all important factors.
- If technical assistance is required contact UltraBaseSystems®.

Most injuries are caused by misuse and/or not following instructions.
Use caution when using this system.



Proudly made in the USA from 100%
recycled and recyclable materials.

866.921.7888 | 727.391.9009
www.UltraBaseSystems.com | www.TourLinks.net

© 2021 Innovative Base Technologies, LLC

List of Tools

- Landscape Rake
- Push Broom
- Shovel
- Plate Compactor
- Weed Wacker
- Round Up Weed Killer (Optional)
- Post Hole Digger (For cup Installation)
- Wheel Barrow (If additional fill material is needed)
- Tour Links Stabilization and Weed Cloth for Installations Over Earth
- Tape Measure
- Carpet Kicker
- Narrow Crown Staple Gun and Stainless Steel Staples – 1/4" Wide x 1" Long
- Air Compressor and Hoses for Staple Gun
- Double Sided Carpet Tape for Temporary Installations
- Tacky Tar Seal Tape for Temporary Seams
- Utility Knife and Blades
- Seam Roller
- Drawing Chalk



Proudly made in the USA from 100% recycled and recyclable materials.

866.921.7888 | 727.391.9009
www.UltraBaseSystems.com | www.TourLinks.net

© 2021 Innovative Base Technologies, LLC

Parts Identifier

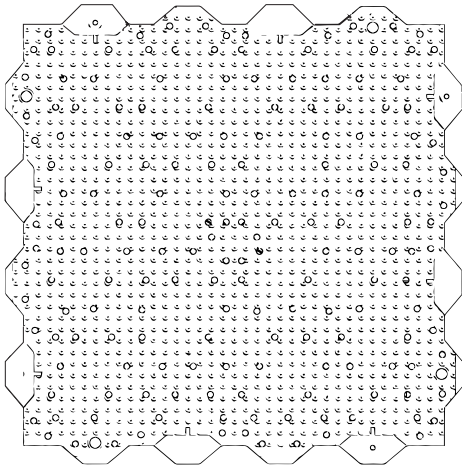

UBS Professional Panel
Part # UBSPRO

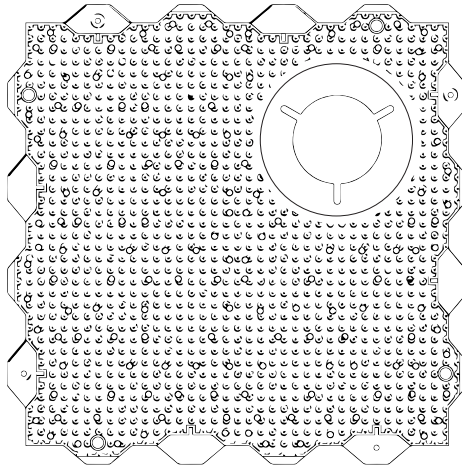

UBS Professional Panel w/Cup
Part # UBSPROCUPHOLE

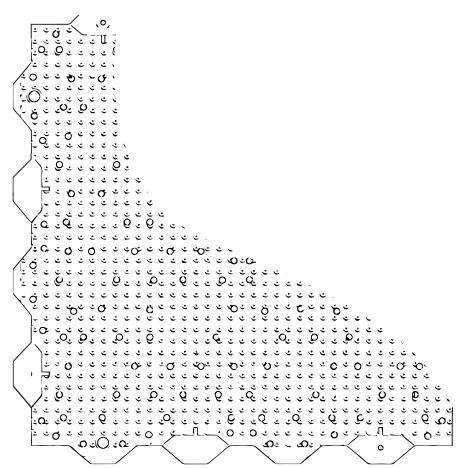

UBS Professional Panel Cut



Retriever Base

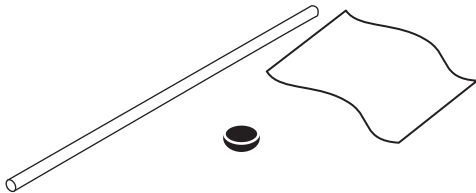

Retriever Pole, Knob and Flag

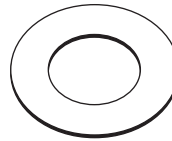

Deck Washer

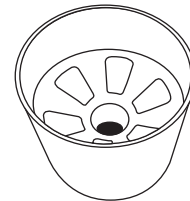

Cup

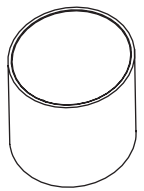

**4" Cup &
Installation
Accessory**

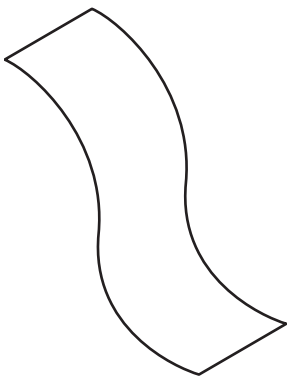

Pre-cut Fringe Turf

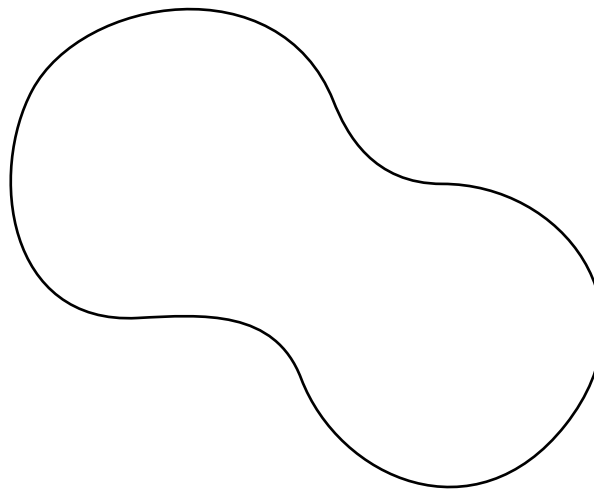

Pre-cut Turf

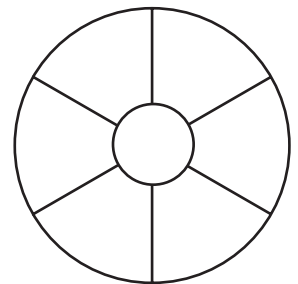

**Styrofoam Contours
(Optional)**



Proudly made in the USA from 100%
recycled and recyclable materials.

866.921.7888 | 727.391.9009
www.UltraBaseSystems.com | www.TourLinks.net

© 2021 Innovative Base Technologies, LLC

Product Identification



IMPORTANT: Identify your model before proceeding with assembly. Illustrations in this manual are representative only. Follow the proper diagram below for set up of your model.



Proudly made in the USA from 100% recycled and recyclable materials.

866.921.7888 | 727.391.9009
www.UltraBaseSystems.com | www.TourLinks.net

© 2021 Innovative Base Technologies, LLC

18x23 Panel Layout

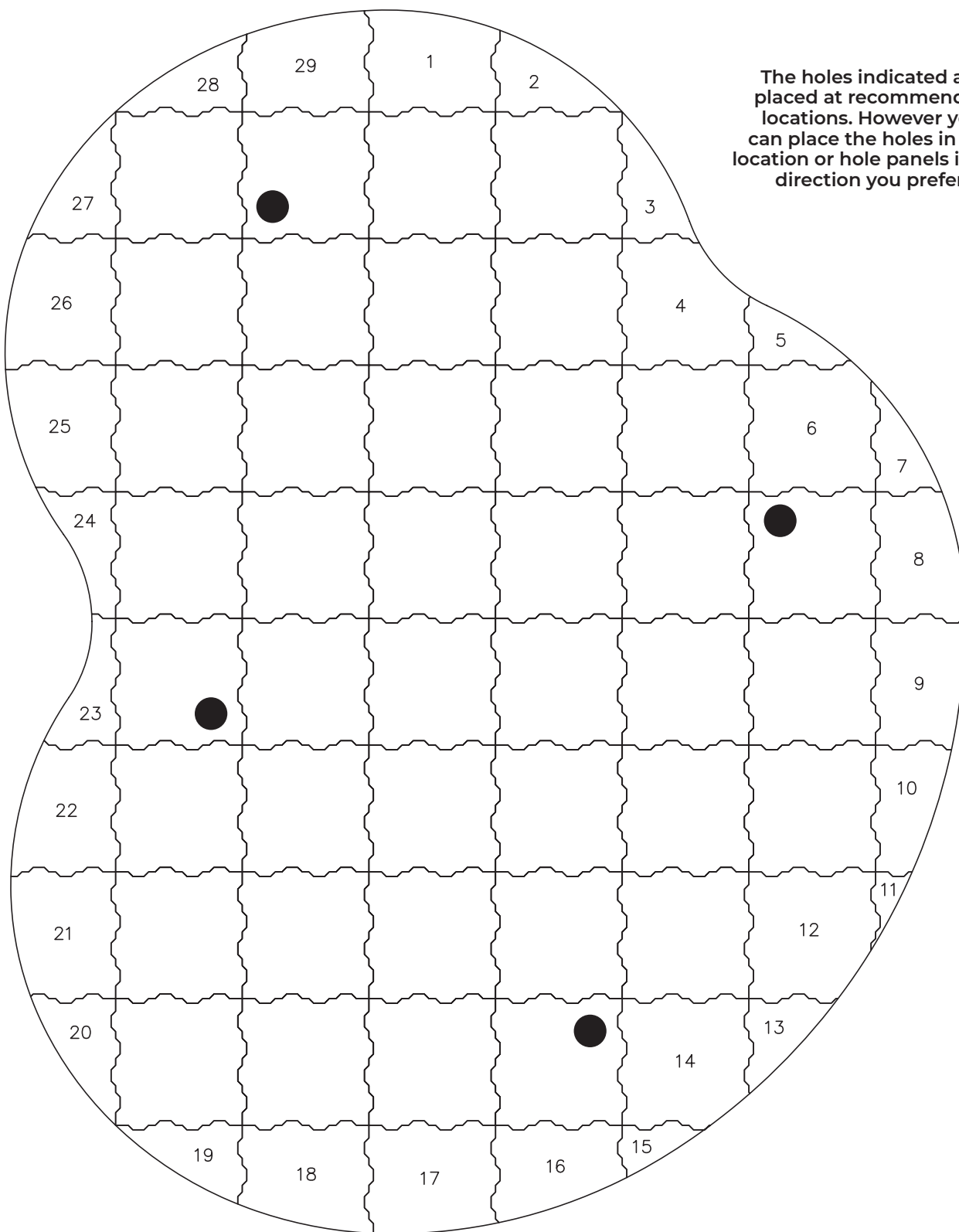

The holes indicated are placed at recommended locations. However you can place the holes in any location or hole panels in any direction you prefer.



Proudly made in the USA from 100% recycled and recyclable materials.

866.921.7888 | 727.391.9009
www.UltraBaseSystems.com | www.TourLinks.net

© 2021 Innovative Base Technologies, LLC

18x23 Fringe Turf Identifier

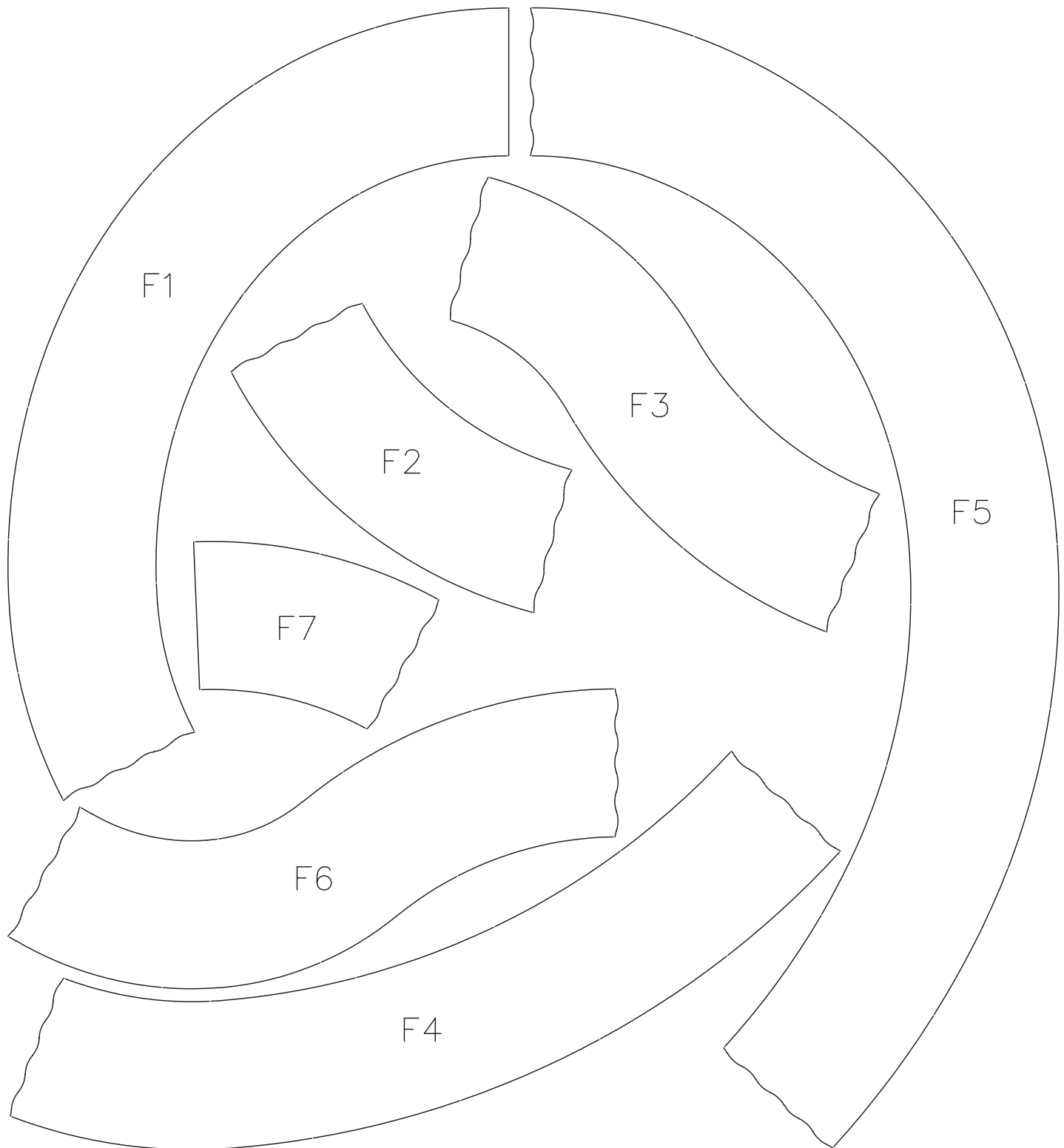

Proudly made in the USA from 100%
recycled and recyclable materials.

866.921.7888 | 727.391.9009
www.UltraBaseSystems.com | www.TourLinks.net

© 2021 Innovative Base Technologies, LLC

18x23 Turf Layout

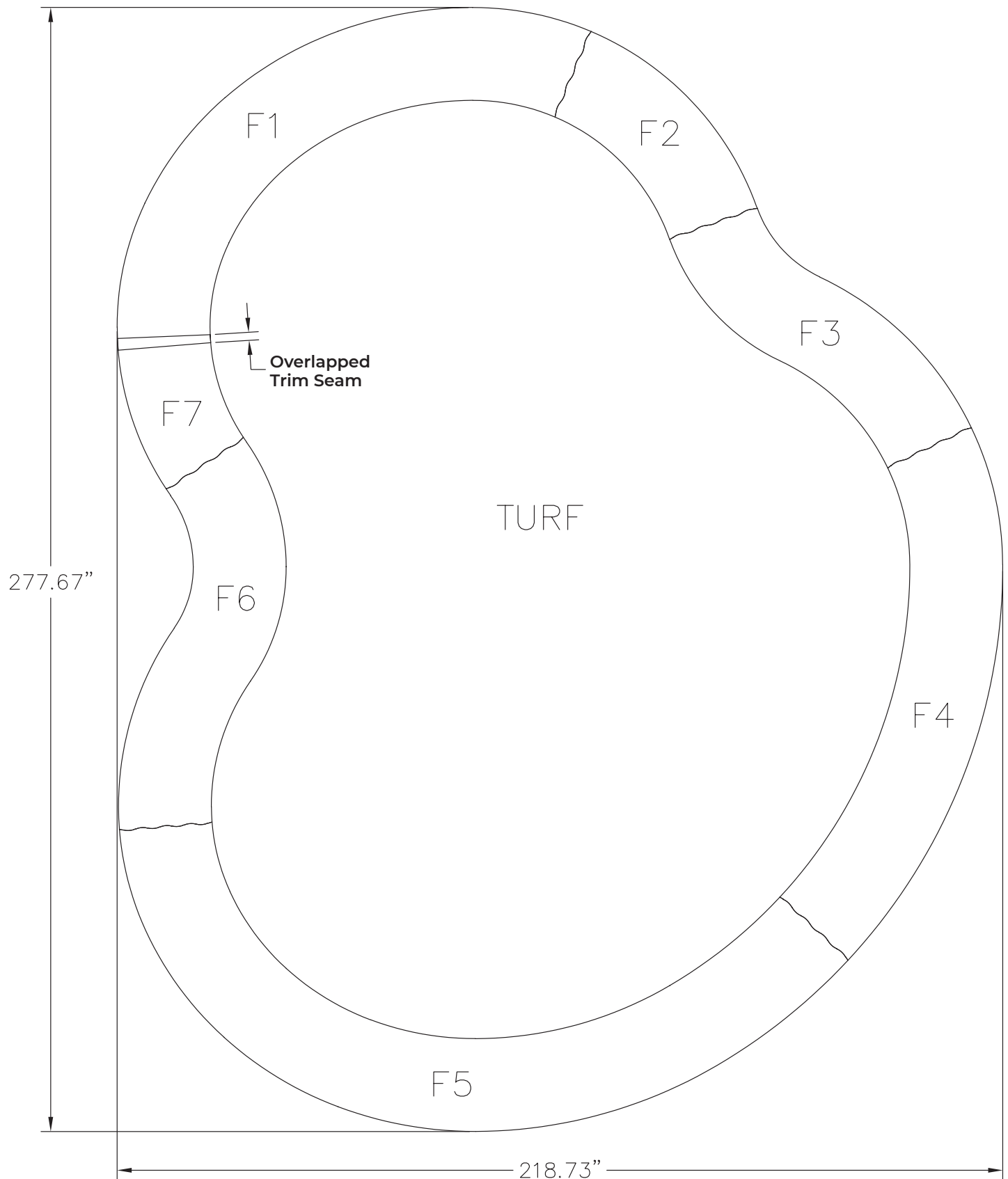

Proudly made in the USA from 100% recycled and recyclable materials.

866.921.7888 | 727.391.9009
www.UltraBaseSystems.com | www.TourLinks.net

© 2021 Innovative Base Technologies, LLC

18x23 Turf & Panel Layout

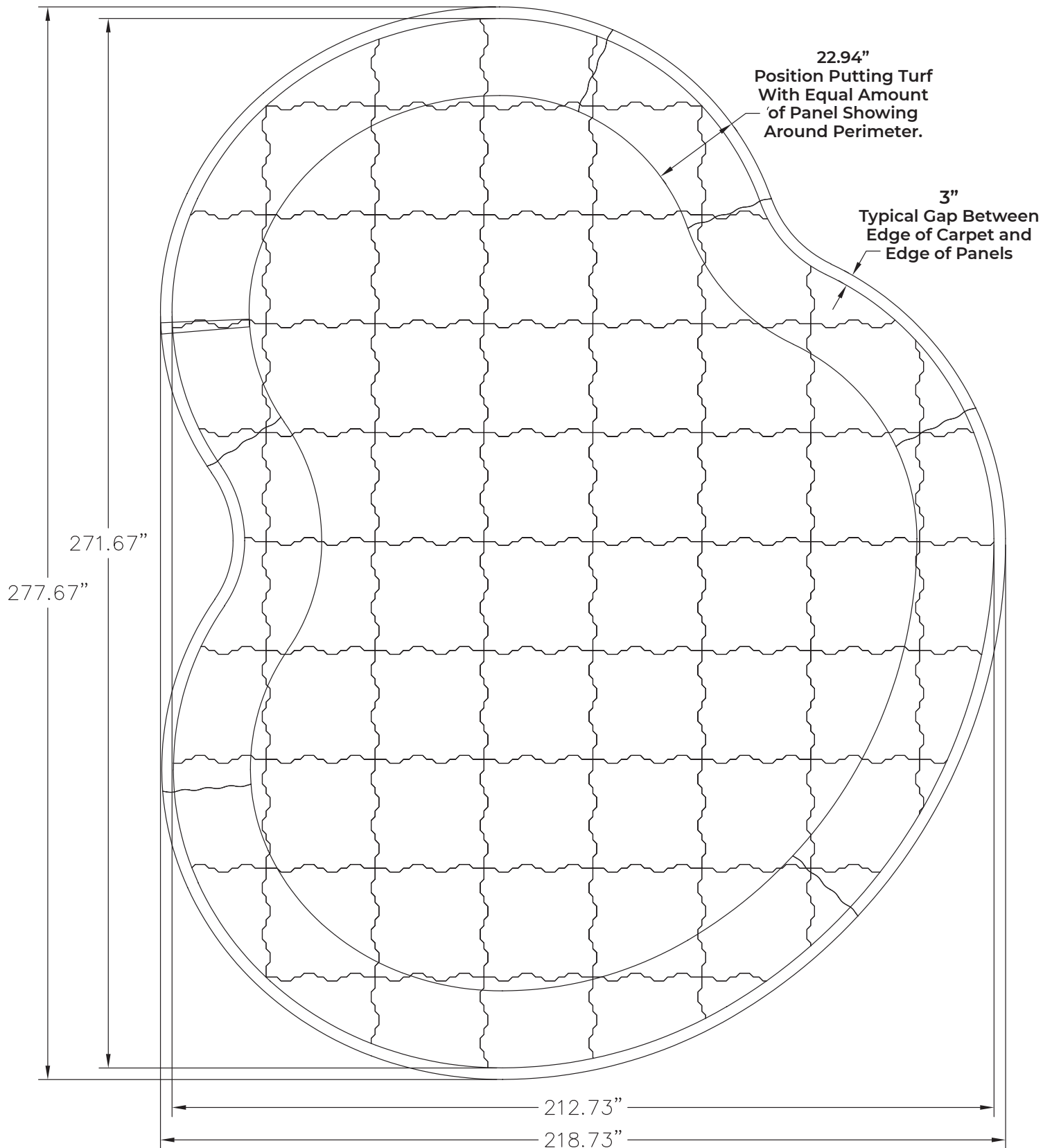

Proudly made in the USA from 100%
recycled and recyclable materials.

866.921.7888 | 727.391.9009
www.UltraBaseSystems.com | www.TourLinks.net

© 2021 Innovative Base Technologies, LLC

15x17 Panel Layout

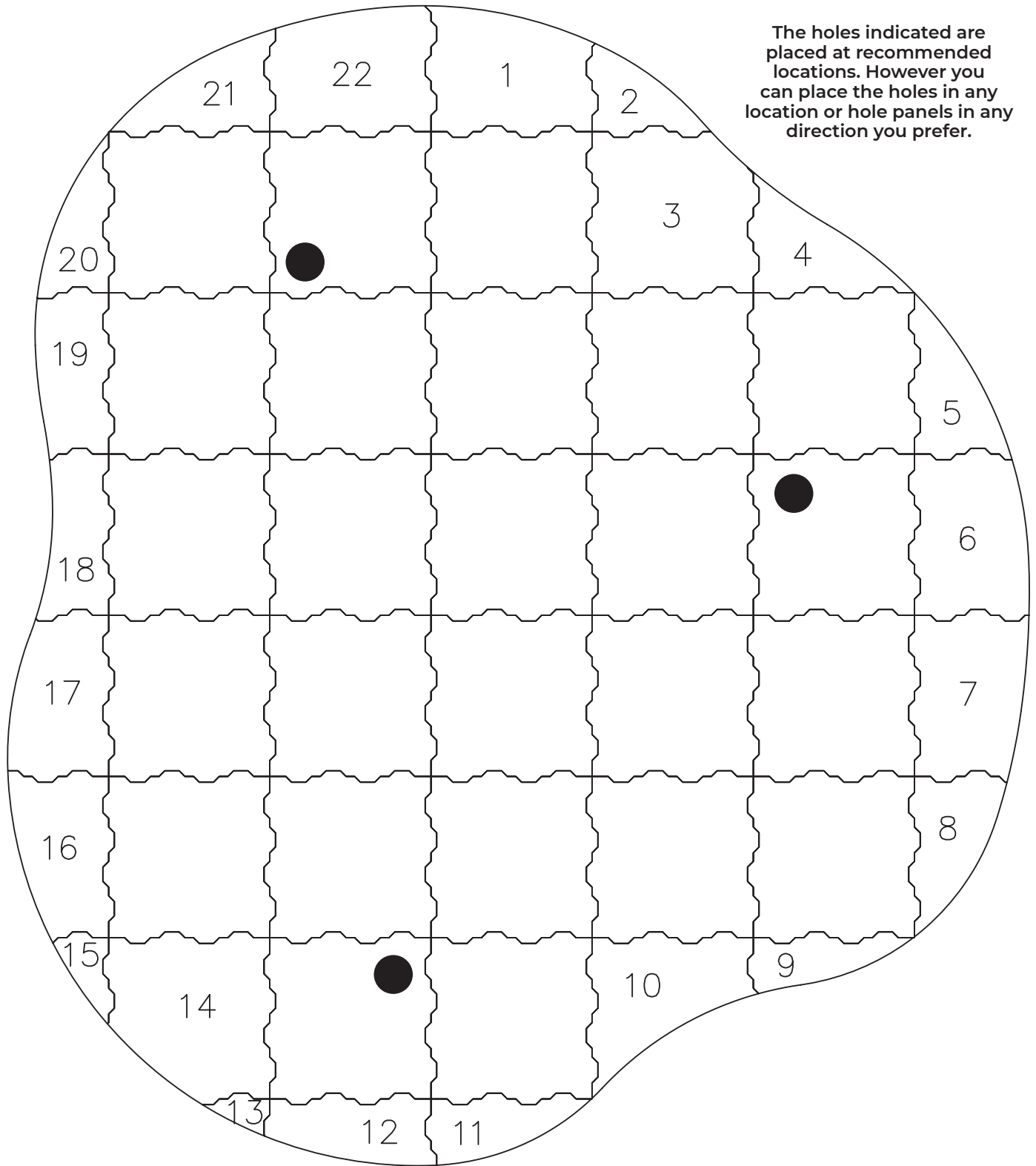

The holes indicated are placed at recommended locations. However you can place the holes in any location or hole panels in any direction you prefer.



Proudly made in the USA from 100% recycled and recyclable materials.

866.921.7888 | 727.391.9009
www.UltraBaseSystems.com | www.TourLinks.net

© 2021 Innovative Base Technologies, LLC

15x17 Fringe Turf Identifier

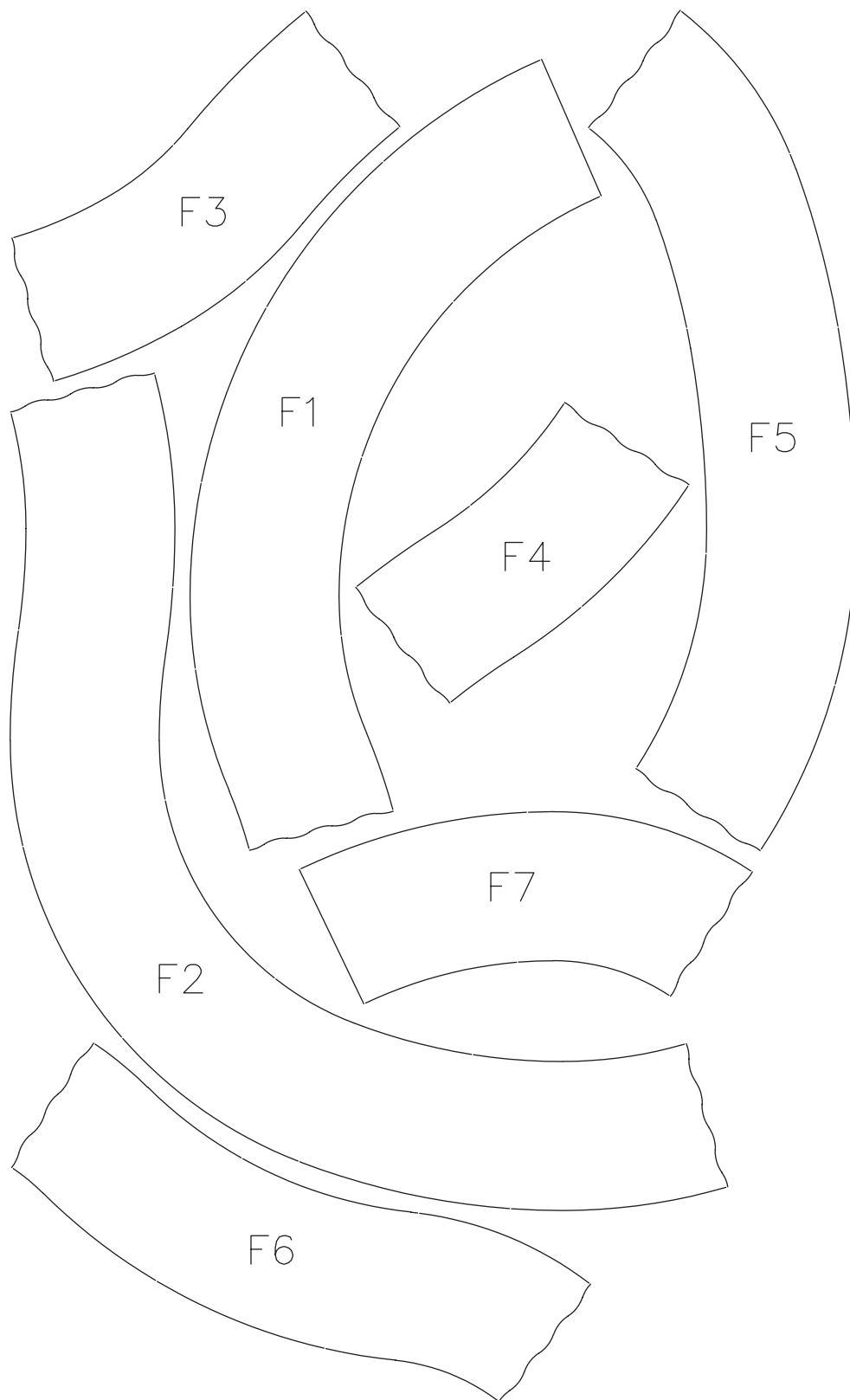

Proudly made in the USA from 100%
recycled and recyclable materials.

866.921.7888 | 727.391.9009
www.UltraBaseSystems.com | www.TourLinks.net

© 2021 Innovative Base Technologies, LLC

15x17 Turf Layout

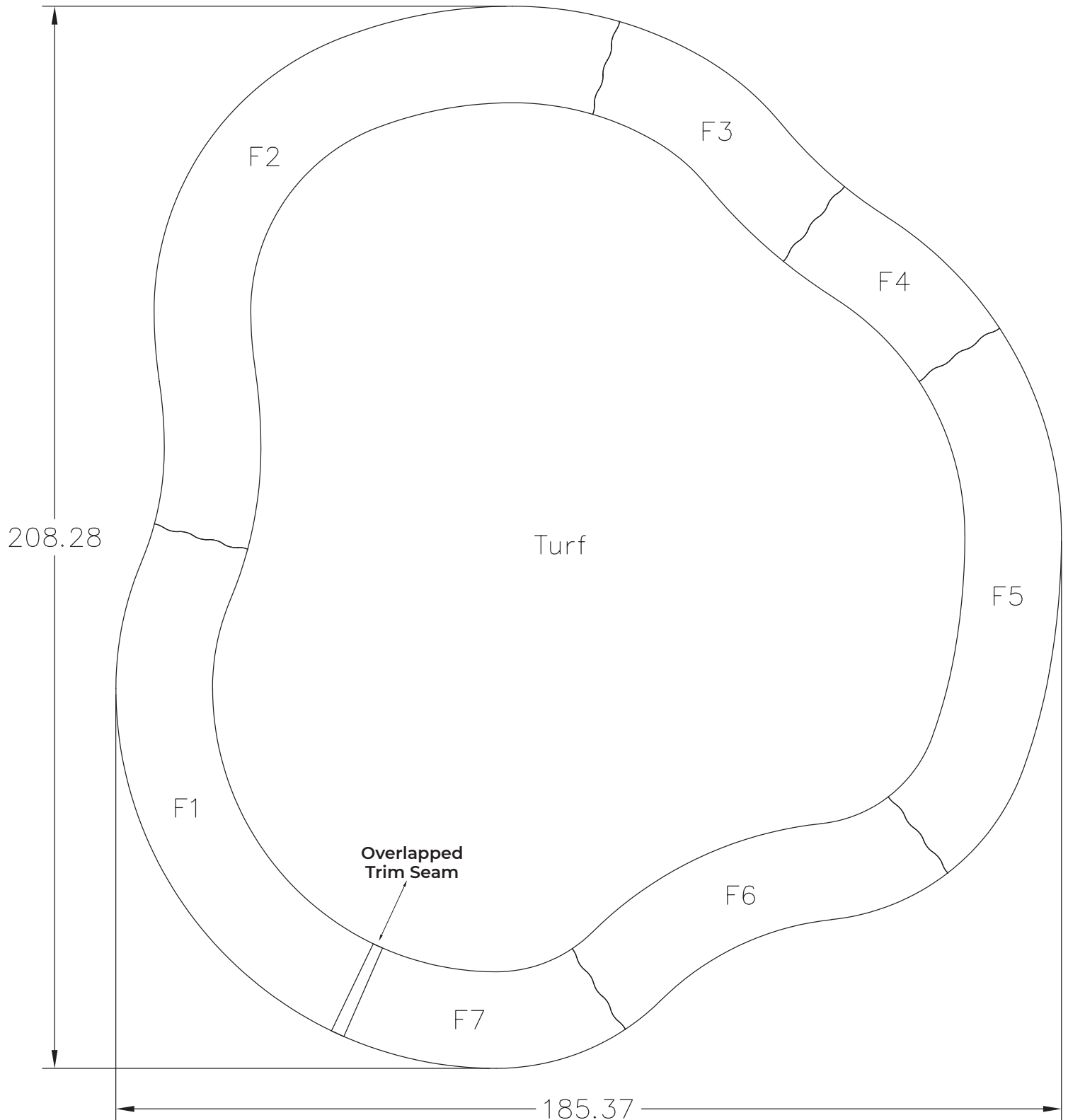

Proudly made in the USA from 100% recycled and recyclable materials.

866.921.7888 | 727.391.9009
www.UltraBaseSystems.com | www.TourLinks.net

© 2021 Innovative Base Technologies, LLC

15x17 Turf & Panel Layout

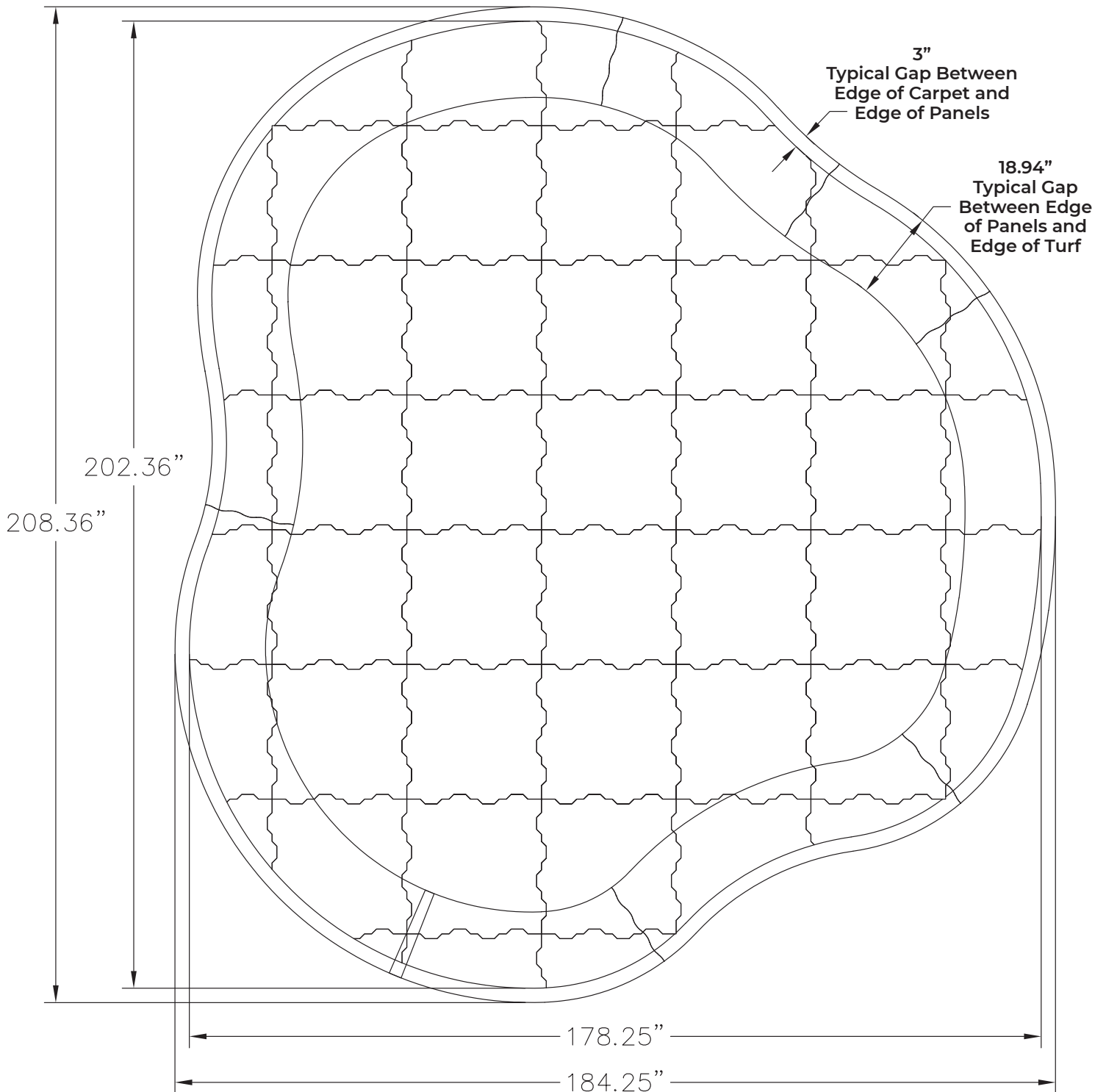

Proudly made in the USA from 100% recycled and recyclable materials.

866.921.7888 | 727.391.9009
www.UltraBaseSystems.com | www.TourLinks.net

© 2021 Innovative Base Technologies, LLC

Installation



INSTALLATION VIDEO

Go to the link below to watch installation instruction video.

<https://ultrabasesystems.com/new-designer-greens/>

1



Turf arrives in two rolls, one putting turf and one fringe turf.

2



Putting turf unrolled and tabs are cut free.

4



Fringe sections are separated and sorted.

3



Fringe turf unrolled.

5



The computer makes easy work of cutting the fringe.

6



Turf and fringe laid flat in the sun. The heat will relax the turf.

7



Pre-cut panels arrive in boxes. All panels are labeled on rear and ready to assemble.



Proudly made in the USA from 100% recycled and recyclable materials.

866.921.7888 | 727.391.9009
www.UltraBaseSystems.com | www.TourLinks.net

© 2021 Innovative Base Technologies, LLC

Installation

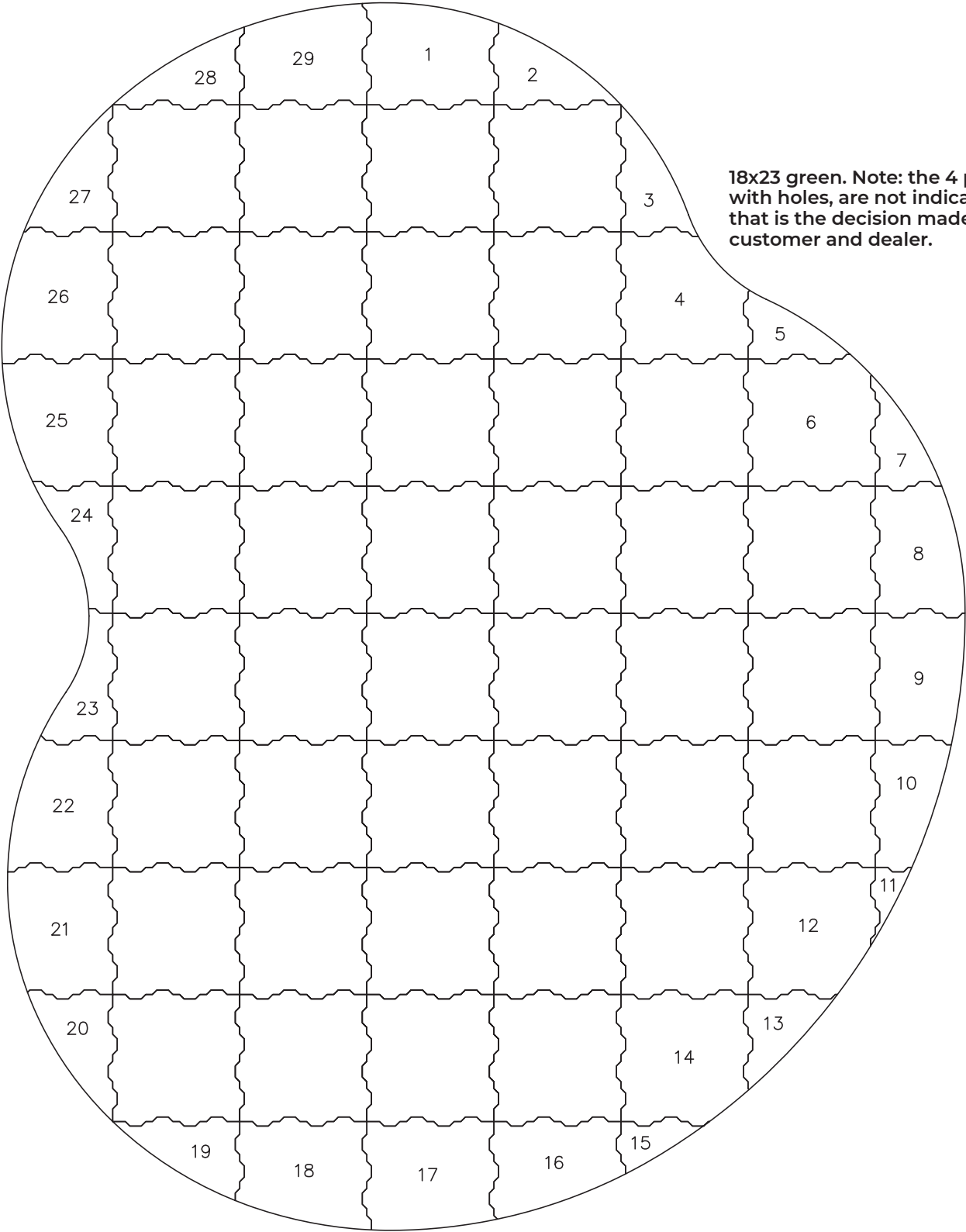

Proudly made in the USA from 100% recycled and recyclable materials.

866.921.7888 | 727.391.9009
www.UltraBaseSystems.com | www.TourLinks.net

© 2021 Innovative Base Technologies, LLC

Installation

8



pre-cut edge panels are laid out in approximate positions.

9



Center panels are placed in approximate positions. Now is the time to place your hole locations.

10



Assembly begins.

11



Half way done.

12



Last pieces are assembled using proper panel installation method.

13



Panels are unpacked and assembled in less than 1/2 hour. Make sure to leave proper gapping between panels.



Proudly made in the USA from 100% recycled and recyclable materials.

866.921.7888 | 727.391.9009
www.UltraBaseSystems.com | www.TourLinks.net

© 2021 Innovative Base Technologies, LLC

Installation

14



Install the regulation cup assembly and cups according to cup installation instructions.

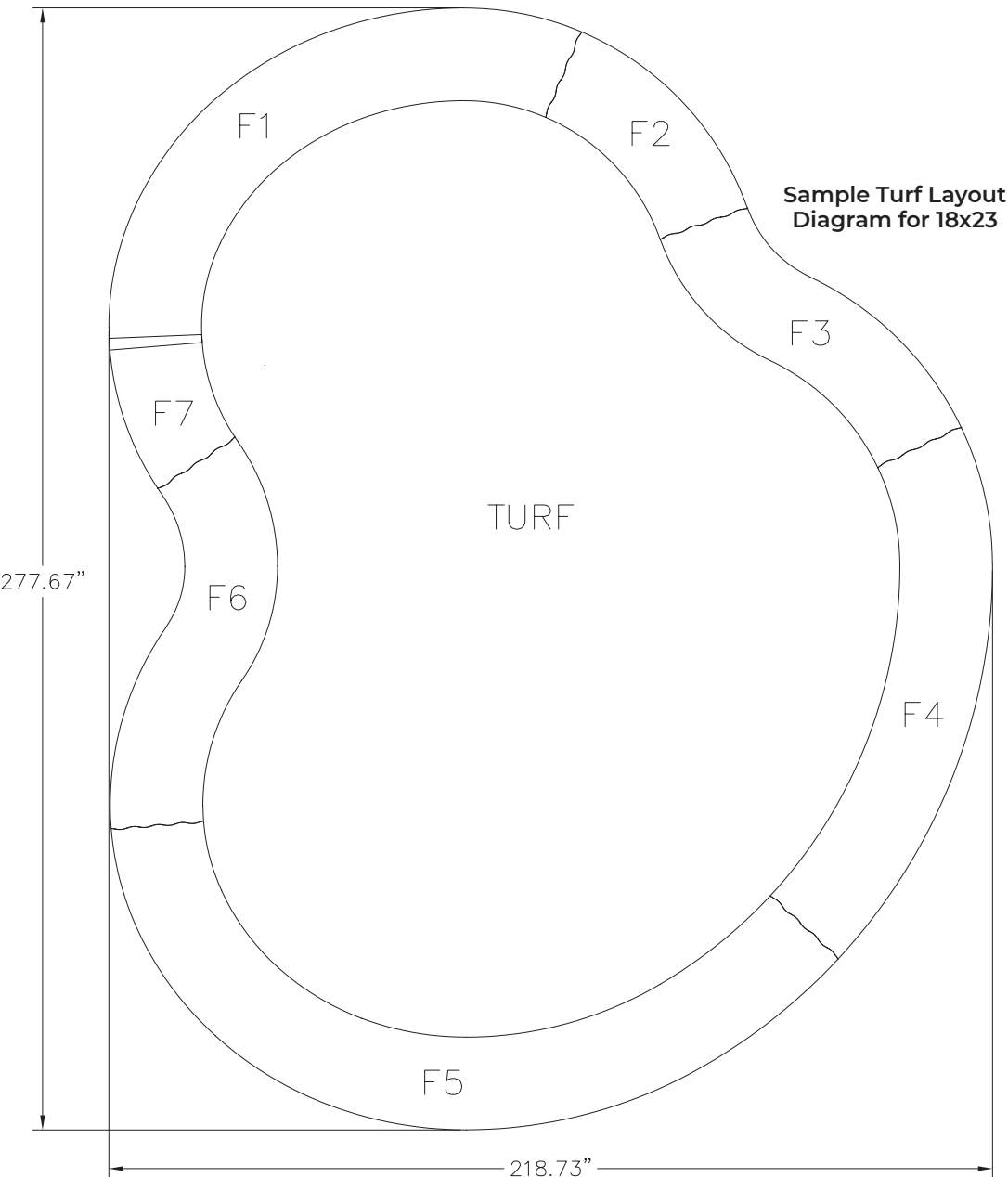

Sample Turf Layout Diagram for 18x23



Proudly made in the USA from 100% recycled and recyclable materials.

866.921.7888 | 727.391.9009
www.UltraBaseSystems.com | www.TourLinks.net

© 2021 Innovative Base Technologies, LLC

Cup Installation

1. Insert the 3 set screws into the side of the filler plate. Fig.1
2. Insert the two 6" bolts through top of filler plate. Fig. 2
3. Thread the two bolts on to the support bracket. Fig. 3
4. Check the position of the 3 set screws to allow the cup to pass through the filler plate opening down to the support bracket. If they need to be adjusted out use a Phillips head screwdriver. Fig 4
5. Insert a 6" or 4 " cup through the top of filler plate.
6. Adjust the cup height by equally tightening or loosening the two long bolts. Fig 4
7. Adjust the 3 set screw to jut touch the cup. If the cup is straight all 3 screws should be turned in the same amount. Fig 5
8. If the panel is on a slope the the cup can be tilted up to 10 degrees by tightening on bolt more then the other. Fig 6
9. Remove the entire cup accessory from the panel and tighten the 3 set screws until they just touch the cup. A tilted cup will have the set screws turned in different amounts.. You may need to check the fit a few times to get it just right. All you are trying to achieve is a firm fit. This will add great lateral stability to the cup when installed in the panel. Don't force the cup in place, as you may not be able to get it out in the future. Fig 7, Fig 8, Fig 9
10. Once the fit is achieved lightly sand and scratch the outside of the cup at the filler plate level in preparation of gluing. Fig 10
11. Wipe the cup and plate clean and apply a thin bead of high temperature hot melt glue to the outside of cup to lock it on to the filler plate. We have found that industrial hot melt glue works fast and is very strong. Do Not us a low temperature craft hot glue. Fig 11
12. Insert the cup assembly into the panels as usual and install the deck washer. Fig 12
13. This new assembly does not have as much float as the normal Tour Links cup. However more movement can be achieved by cutting the interior opening of the hole in the panels larger using a jig saw. Don't remove too much material from the panel, about 1/4 to 1/2 inch ring will be plenty. Some installers will permanently staple the assembly to the panel to achieve a more rigid cup but this will eliminate ALL float and is the decision of the installer to do so. This technique could be used in a high wind environment to help stabilize a 7ft tall flag stick. Fig 13

Fig. 1

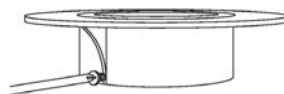

Fig. 2



Fig. 3

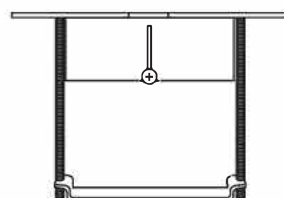

Fig. 4

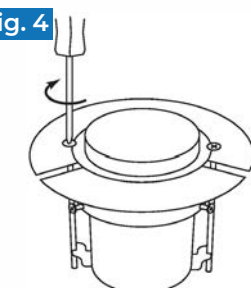

Fig. 5

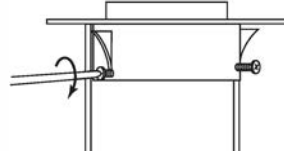

Fig. 6

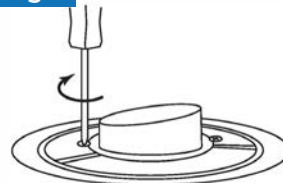

Fig. 7

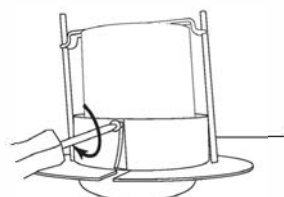

Fig. 8

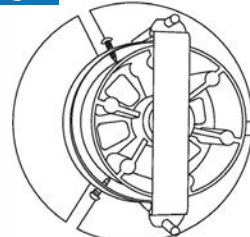

Fig. 9

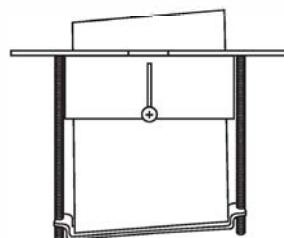

Fig. 10



Fig. 11

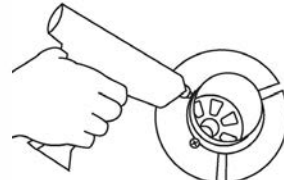
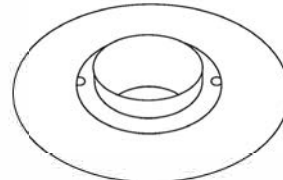

Fig. 12



Cup Installation

14. Install turf as usual.

If the cups are used on high pile turf it may be necessary to adjust to the proper height after the turf has been installed and the cups cut. Simply lift back the turf and adjust the 2 long bolts to achieve the proper height. Make sure the setscrews are still resting against the outside of the cup for stability.

Fig. 13

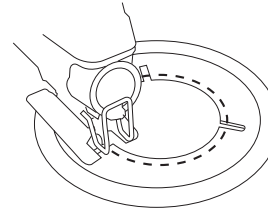

Creating the in ground sleeve for a full length cup

1. Place the ICC panel in the proper location and carefully mark the hole location on the weed cloth. Remove the panel. Fig. 14
2. Cut the weed mat and excavate the hole to the depth of the internal sleeve. We have found a small plastic bucket around 8" Diameter and about 8" deep works great. Fig. 15
3. Cut some large holes in the bottom of the bucket to allow for drainage. Fig. 16
4. Once the hole is cleaned out insert the bucket to ground level and replace the panel to check alignment. Be sure to excavate down about 3" deeper than the bucket.
5. Remove the panel and bucket and pour about 3" of gravel in to the hole. Fig. 17
6. Insert the bucket to earth level and backfill all around the bucket to secure in place. You may need to remove or add a bit of gravel to get to the proper height. Which is even with the ground level. Be sure to compact earth firmly around bucket and on top.
7. Place a new piece of weed cloth over the bucket and spike in place. Fig. 18
8. Cut a hole in the cloth using the inside of the bucket as a guide.
9. Replace the panel. Fig. 19
10. Install the Cup accessory when you are ready for cup installation.

Fig. 14



Fig. 15



Fig. 16



Fig. 17



Fig. 18



Fig. 19



Installation



Relaxed turf is positioned on to the panels leaving equal panel spacing between edge of turf and outside panel edge.



Turf is positioned on panels.



In this case 16" of panels are left exposed around the entire perimeter. The extra fringe turf will wrap over the edge. We are leaving 3" of turf to wrap and staple and then bury.



Fringe sections are fitted into the proper sequence.



Fit all fringe seams.



Turf is kicked and stapled to panels. Do not over kick and move turf out of position. You are just trying to remove any wrinkles and tighten the turf. This is always best done when it is hot outside.



Proudly made in the USA from 100% recycled and recyclable materials.

866.921.7888 | 727.391.9009
www.UltraBaseSystems.com | www.TourLinks.net

© 2021 Innovative Base Technologies, LLC

Installation

21



Staple the putting turf to panels. For temporary installations use double sided carpet tape.

22



Staple fringe seams. Use single sided carpet tape for a temporary installation.

23



In some situations stapling the turfs to the panels will not be the best option. For instance a temporary installation for a trade show or event or one where the customer may move the green from place to place, having all the turfs stapled to the panels would not be advisable. For these installations using a single sided 6" wide gutter and flashing tar tape would be the best way to attach the putting turf to the fringe. In essence you have created a big area rug that can just be laid out on to the panels.



24



Roll the seams with a seam roller to achieve a good blend.

25



Turf is stapled to the outer most edge of the panels and then wrapped and stapled to the panel sides.



Proudly made in the USA from 100% recycled and recyclable materials.

866.921.7888 | 727.391.9009
www.UltraBaseSystems.com | www.TourLinks.net

© 2021 Innovative Base Technologies, LLC

Installation

26



Text for temporarily taping the cup while you cut a hole in the turf.

27



After the turf has been stretched it will be necessary to pierce through the carpeting and carefully cut the cups. Use the outside radius of the cups edge as your guide. This technique will take practice to master. Once the cup is cut, remove the temporary spike in the bottom of the cup to restore cup motion. Continue this process for every hole.



Go to the link below to watch installation instruction video.
<https://ultrabasesystems.com/new-designer-greens/>



Finished green had holes cut and landscaped to achieve that built in look.



Proudly made in the USA from 100%
recycled and recyclable materials.

866.921.7888 | 727.391.9009
www.UltraBaseSystems.com | www.TourLinks.net

© 2021 Innovative Base Technologies, LLC



WARRANTY

Innovative Base Technologies, LLC, a Florida corporation ("Seller") warrants to the original purchaser of UltraBase interlocking modular panel(s) ("Buyer") that the interlocking modular UltraBase panel(s) ("Panel(s)"), provided that they are properly stored prior to installation to ensure distortion does not occur, installed and maintained, are warranted against cracking, shattering, splitting or deterioration, under normal and proper use as one component of an artificial turf surface or athletic sport tile and the Panel(s) shall be free from defects in material and workmanship for a period of ten (10) years after the date of delivery to the Buyer ("Limited Warranty Period").

Seller will indemnify, defend (with counsel of Seller's choice) and hold harmless the Buyer against any loss, liability or claim arising from breach of this Limited Warranty, solely to the extent set forth below. If Seller, in Seller's reasonable determination determines that any Panel(s) do not conform to this Limited Warranty, Seller, at Seller's sole option will repair or replace the non-conforming Panel(s). The remedy under this Limited Warranty is expressly limited to repair or replacement of defects in materials or workmanship, and does not include incidental or consequential damages which are specifically disclaimed. Some states in the United States do not allow the exclusion or limitation of incidental or consequential damages, so the limitations or exclusions may not apply to you.



Proudly made in the USA from 100%
recycled and recyclable materials.

866.921.7888 | 727.391.9009
www.UltraBaseSystems.com | www.TourLinks.net

© 2021 Innovative Base Technologies, LLC



BUILDING SMARTER

5030 Seminole Blvd.
Saint Petersburg, FL 33708

727-391-9009 or **866-921-7888**

www.ultrabasesystems.com

www.tourlinks.net

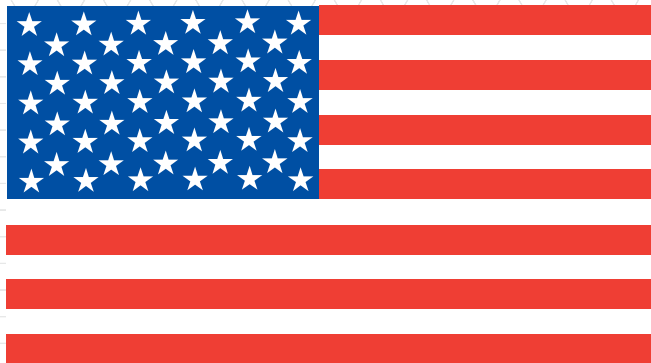

MADE IN USA